

BEARING, BALL

Turbine Kinetics Part Number KTJ1170P01-P02

General Electric Part Number J1170P01-P02

Model Eligibility:
See FAA/PMA Supplement

IPC Reference:

CF6-80-72-00
CF6-80-72-56
CF6-80-75-00
CF6-80-75-20

Quantity Per Engine:

As Required

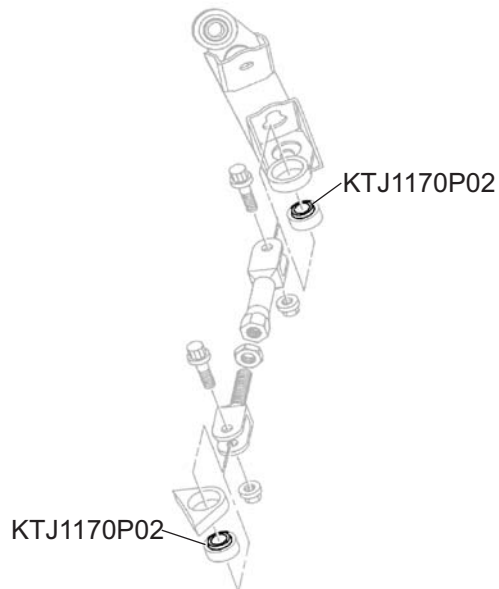

Engine Location:

Rotor/Stator Assembly -LPT,
Engine Air, and Additional
Engine Locations

