

## BOLT

Turbine Kinetics Part Number 9138M30P01QQ, P05QQ  
General Electric Part Number 9138M30P01, P05

**Engine Eligibility:**  
See FAA/PMA Supplement

**IPC Reference:**  
CF6-72-52

**Quantity Per Engine:**  
As Required

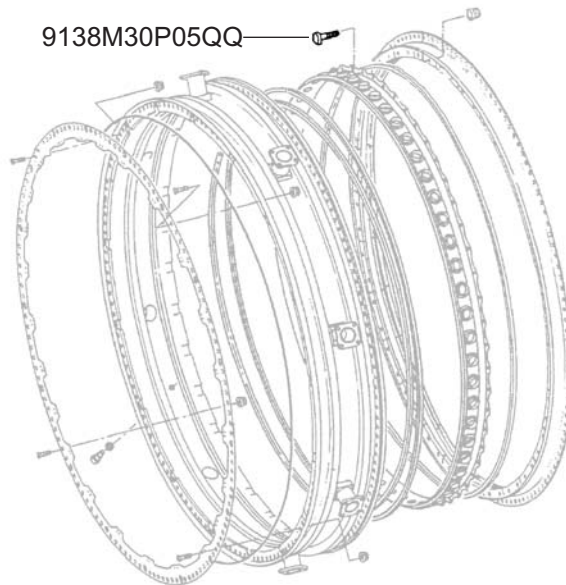

**Engine Location:**  
Nozzle Assembly - HPT Stage 2

